

This page is for your use only, to help plan where guests will sit and sleep.

Front Door

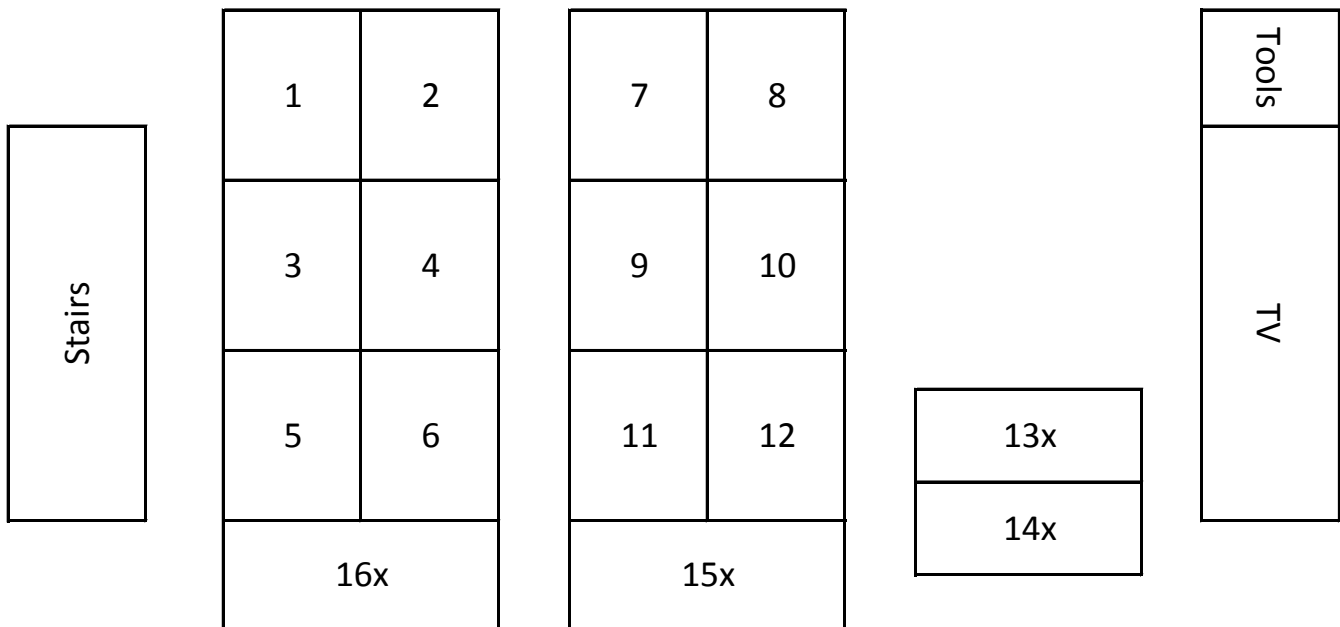

Kitchen

Table Layout: I recommend not using tables with a X if you only have 12 guests.

**Main Floor:**

2 Twins \_\_\_\_\_ 1 Twin \_\_\_\_\_  
 \_\_\_\_\_

**Upstairs:**

3 Twins \_\_\_\_\_ 3 Twins \_\_\_\_\_ 3 Twins \_\_\_\_\_  
 \_\_\_\_\_  
 \_\_\_\_\_

(Middle room is the warmest)

**Lower Level:**

1 Double \_\_\_\_\_ 1 Queen \_\_\_\_\_ 2 Twins \_\_\_\_\_  
 \_\_\_\_\_